

## TUBULAR ACTUATOR PROGRAMMING STATEMENT

The Centre of alup; Company in Bielsko-Biala  
ul. Warszawska 153, 43-300 Bielsko Biala, Poland  
Tel. + 48 33 81 95 300, fax. + 48 33 82 28 512

The plant in Opole  
ul. Gostawicka 3, 45-446 Opole, Poland  
Tel. + 48 77 40 00 000, fax. + 48 77 40 00 006  
e-mail: Aluprof@aluprof.eu



DM 35/45 R  
DM 45/55/59 RM



Built-in radio receiver

Work in pulsed mode

Mechanical krańcówki

### Technical specification

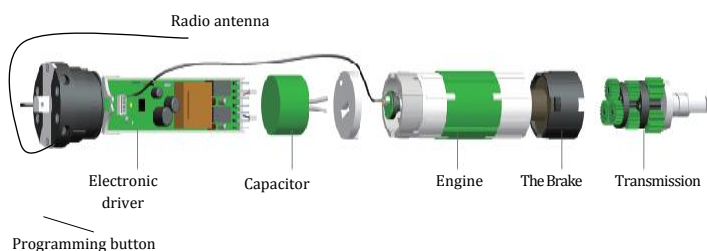

1. Enter basic settings via wowych ustawień za pośrednictwem portable transmitter:go.
2. The ability to program up to 20 transmitters on one ednym the actuator. Following the next transmitters cause overwriting initially programmed, ramowanych.
3. Precise mechanical positioning, nie pozycji krańcowych.
4. Sound signalling movement when callings wywoływania any settings. tawień.

### The ranges of a correct response portable transmitters

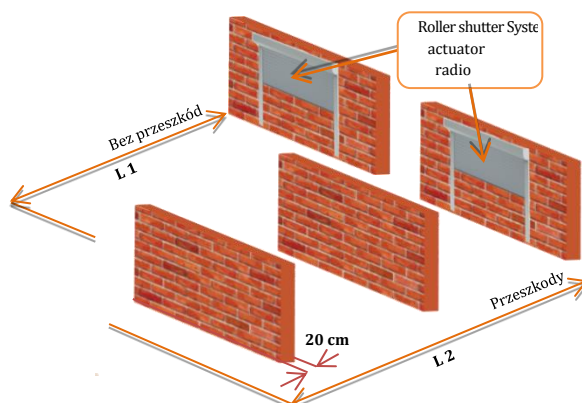

	L1	L 2	The Frequency Of transmission
230V/50 Hz	200 m	35 m	433.92 MHz

## Description of the transr

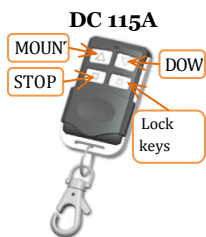
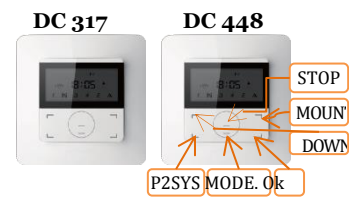
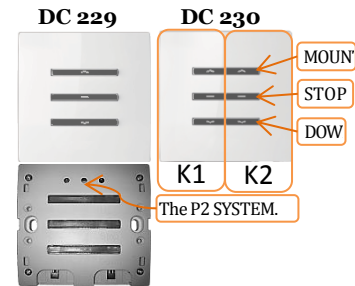
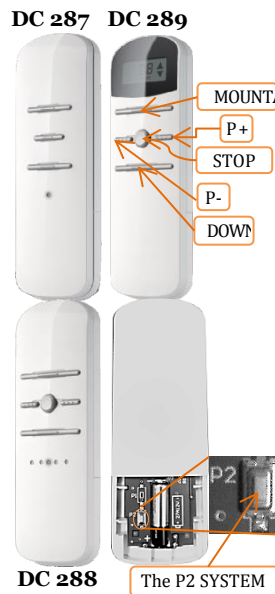

Activate the button "system P2 "DC115A transmitters We make by combining at the same time, przyciśniętych the buttons "STOP" and "mountain".

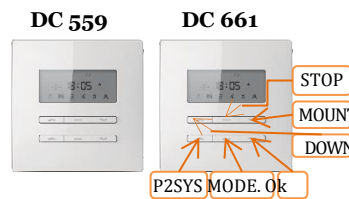

In order to program the clock along with date display hold "MODE" button for 4 seconds to the ia migan Sprite "vintage". Change the numbers, we make the buttons "top and bottom" and if all interesting us settings have been put it, press the "OK" button.

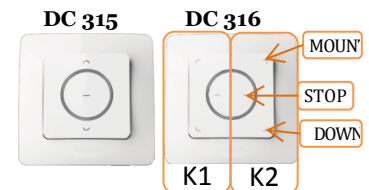

Activate the button "system P2 "DC315 transmitters and DC316 We make by combining at the same time przyciśniętych the buttons "STOP" and "mountain".

### LEGEND:

**MOUNTAIN** - Activation button will move the carapace.

**DOWN** - Activation by ycisku will cause the movement of armor down.

**P2SYS-P2 SYSTEM** - Activation button invokes feature programming.

**P +** - activation of the button switches the transmitter on the next channel.

**P -** - activation of the button switches the transmitter on the previous channel.

**K1** - the first channel buttons.

**K2** - second channel buttons.

**MODE** - the activation button setting the clock and date stamp.

### 1/Connect the actuator to the power supply in accordance with the accepted standards (Figure 1).

After correct entry actuator power once the sound signals (x 1 BIP)

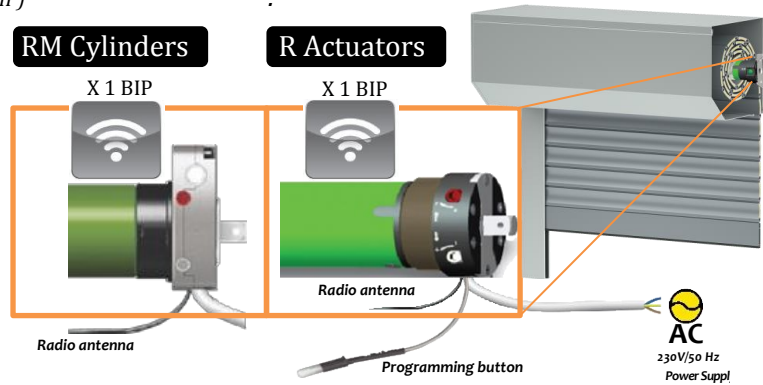
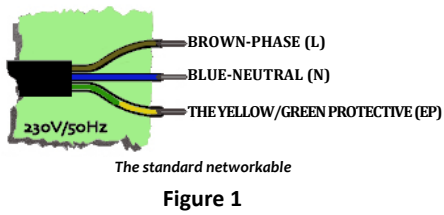

### 2/connection of the actuator with the transmitter.

To connect the transmitter to the actuator:

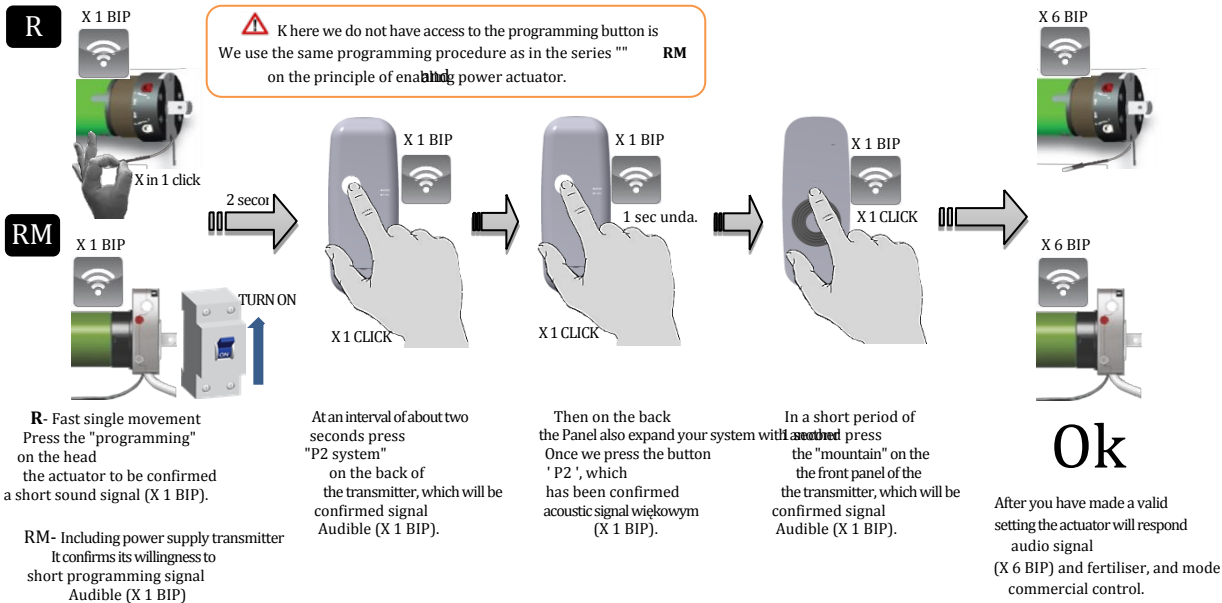

### 3/the base Change the direction of rotation of the actuator.

When connected to the actuator with the transmitter performs the opposite movement to the desired:

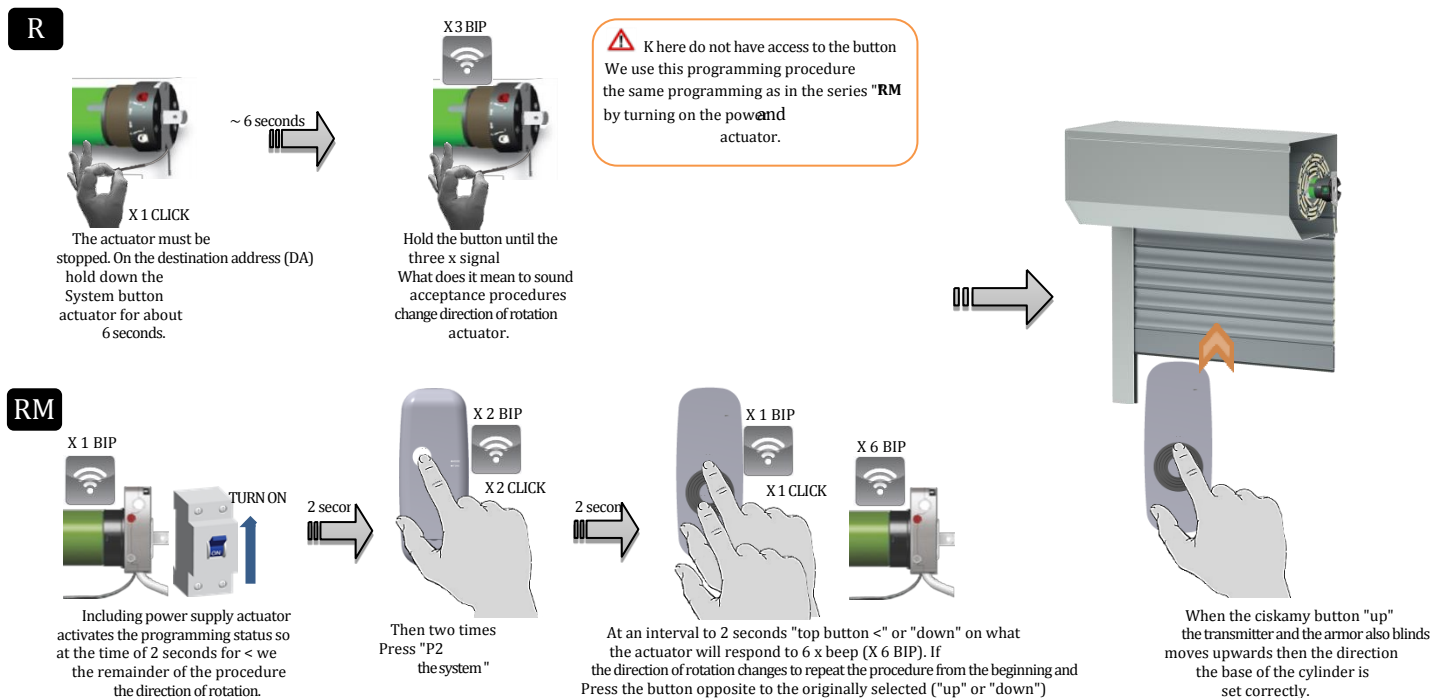

#### 4/programming each transmitter.

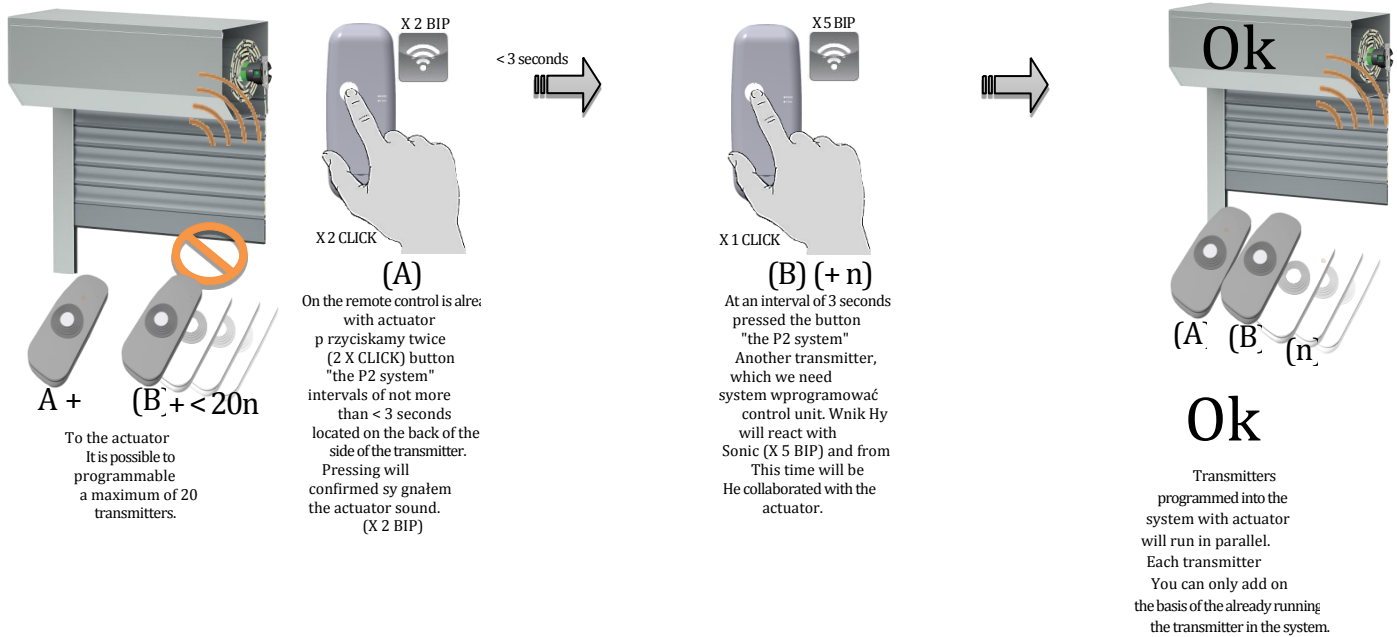

#### 5/Deleting transmitters from your system actuator.

**⚠** The procedure for deleting any transmitter removes all transmitters which were connected with the actuator.

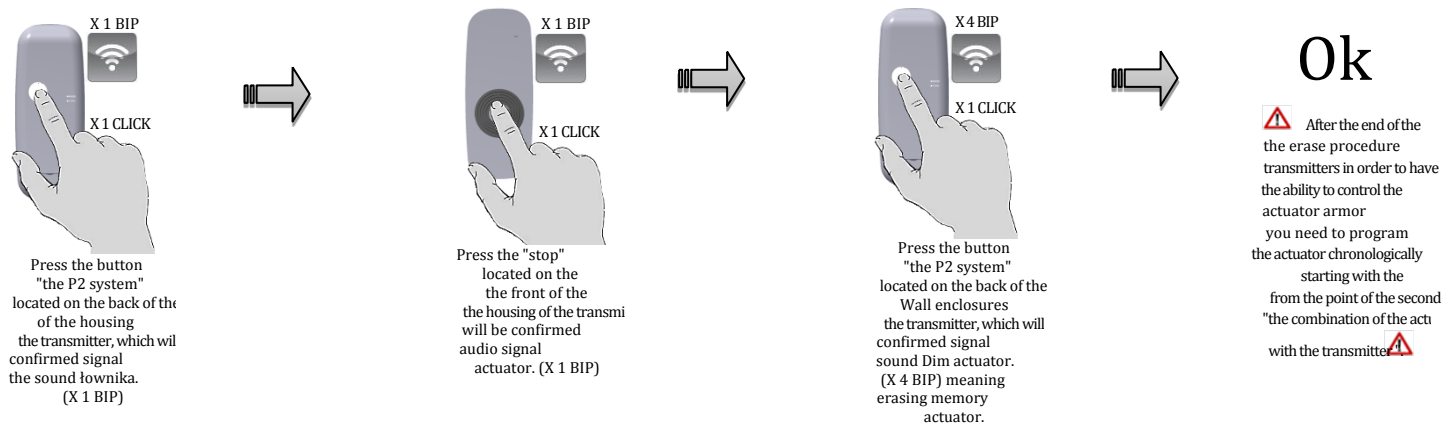

#### 6/pulse mode Activation.

