

Via l'interface web
ou application iPad

2 – Cliquer sur la
bulle sécurité.

The screenshot shows the TaHoma web interface. At the top, there are navigation tabs: 'my home' and 'my security'. The 'my security' tab is circled in red. Below the tabs, there is a header area with a house icon and the text 'Welcome, your TaHoma connected alarm is disabled.' To the left of this text is a circular icon containing a house with a diagonal line through it, labeled 'Disabled', which is also circled in red. To the right of the header, there are two status cards: 'GSM service' and 'Backup battery'. Below the header, there is a section for 'Previous alerts' with two entries: '8 February 2017 - 17:53 Intrusion alert' and '8 February 2017 - 17:50 Intrusion alert'. At the bottom, there are two sections: 'Active detectors' with the text 'Your TaHoma connected alarm is not active. No detector is monitored.' and 'Security equipments' which lists three items: 'base sécurité', 'Sirene io', and 'CAM LTRPW .ISW'. The Somfy logo is at the bottom center.

1 – Aller dans l'onglet "ma sécurité"

Via l'interface web
ou application iPad

The screenshot displays the TaHoma web interface. At the top, there is a navigation bar with the TaHoma logo, tabs for 'my home' and 'my security', and utility icons for notifications, email, and a menu. The main content area is titled '3 - Sélectionner "Editer"' in red text. Below this, a row of security status icons is shown: a grey 'Disabled' icon, a green 'Total' icon, two green 'Partial' icons (labeled 'Partial 1' and 'Partial 2'), and another grey 'Disabled' icon. A red circle highlights the 'Edit' icon (a pencil) on the right side of this row. To the right of the status icons, there are two grey panels: 'GSM service' and 'Backup battery'. Below the status icons, the 'Previous alerts' section shows two entries: '8 February 2017 - 17:53 Intrusion alert'. The 'Active detectors' section states: 'Your TaHoma connected alarm is not active. No detector is monitored.' The 'Security equipments' section lists three items: 'base sécurité', 'Sirene io', and 'CAM LTRPW JSW'. The Somfy logo is at the bottom center.

TaHoma® my home my security

3 - Sélectionner "Editer"

Disabled Total Partial 1 Partial 2 Disabled Edit

GSM service

Backup battery

Previous alerts

8 February 2017 - 17:53 Intrusion alert

8 February 2017 - 17:50 Intrusion alert

Active detectors

Your TaHoma connected alarm is not active. No detector is monitored.

Security equipments

base sécurité Sirene io CAM LTRPW JSW

somfy.

Via l'interface web
ou application iPad

Pour chaque mode:

- Total
- Partial 1
- Partial 2

Avec la base sirène
précédemment
activée.

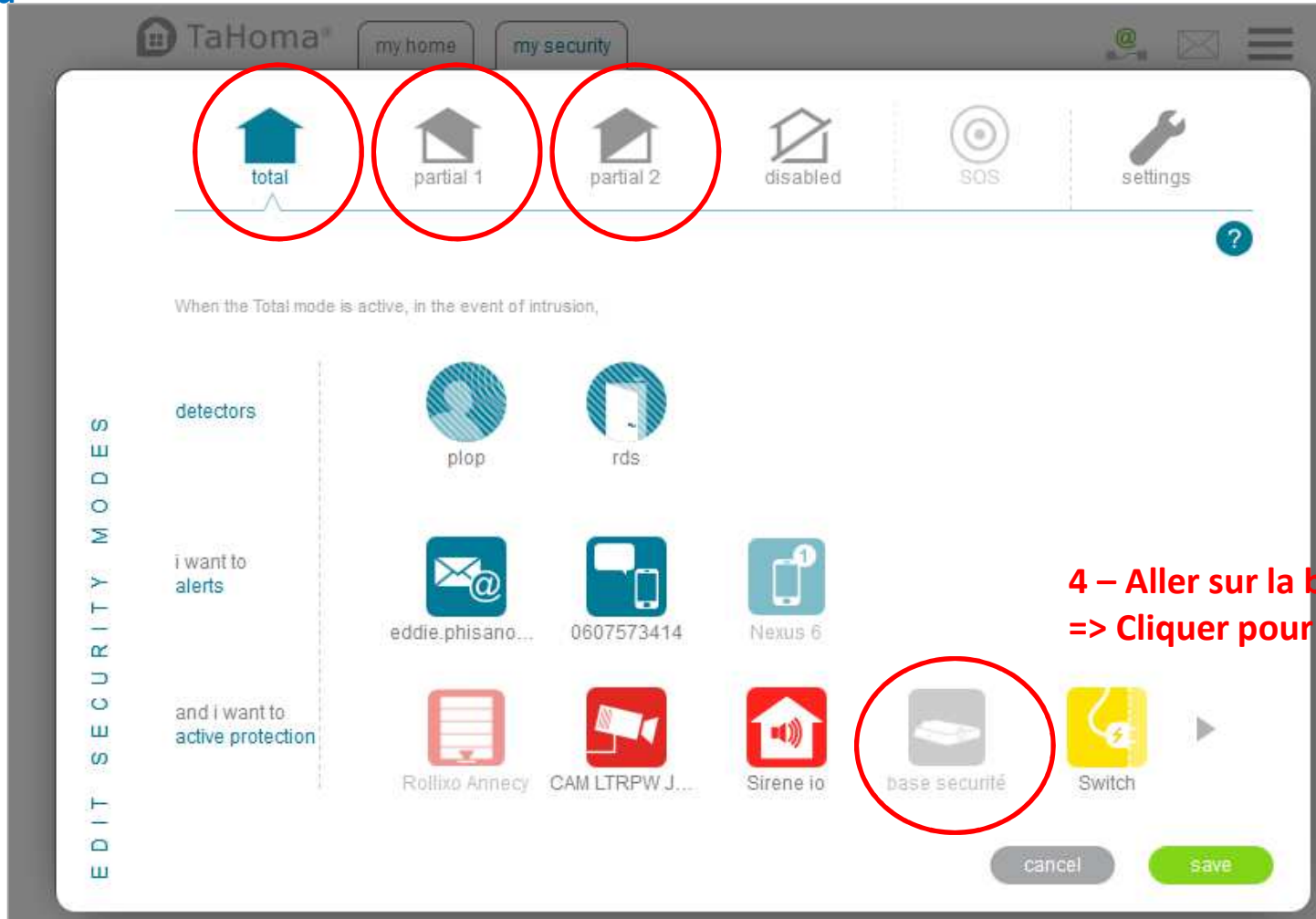

4 – Aller sur la base sirène.
=> Cliquer pour la griser.

Via l'interface web
ou application iPad

Pour chaque mode:

- Total
- Partial 1
- Partial 2

Avec la base sirène
précédemment
activée.

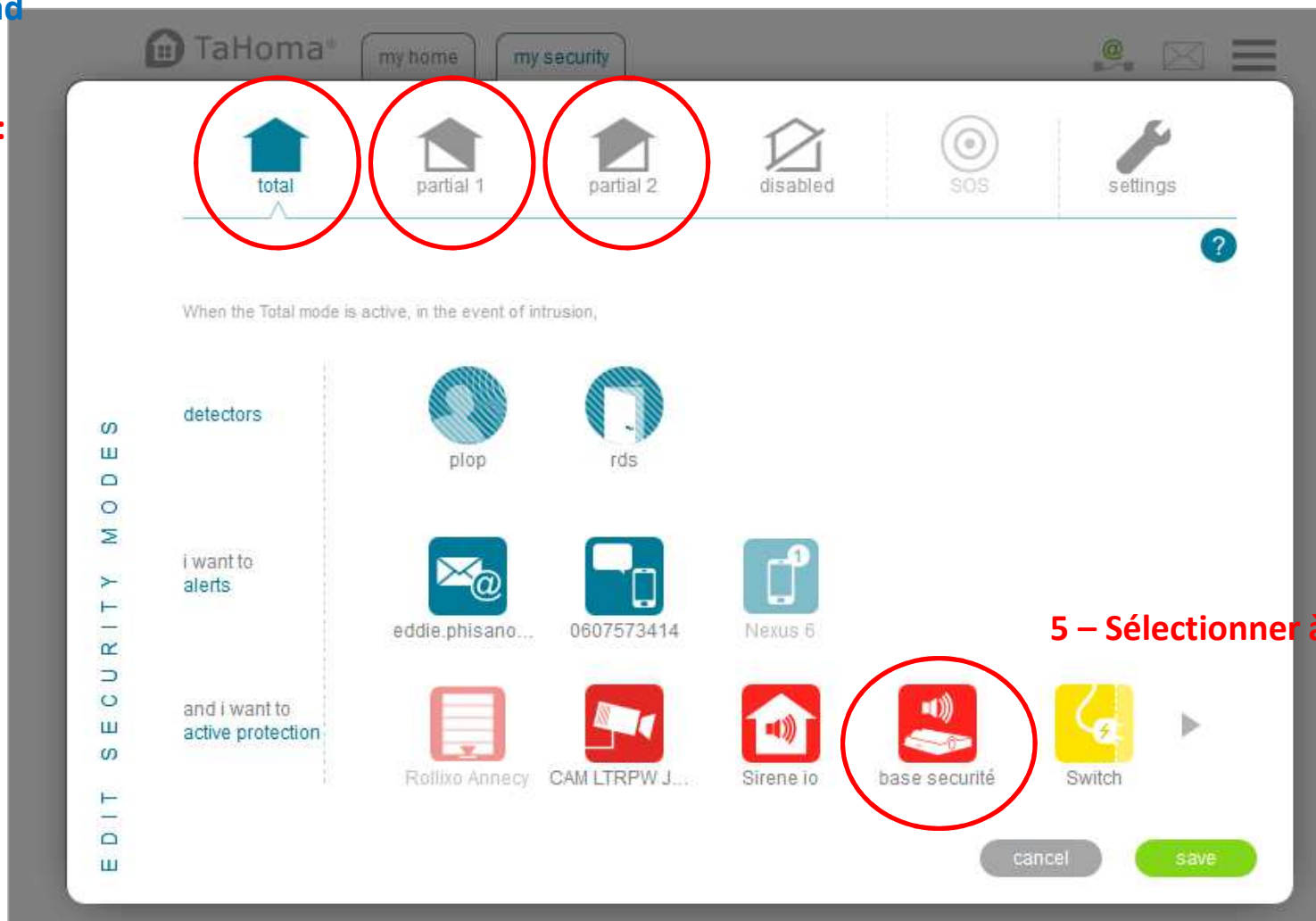

5 - Sélectionner à nouveau

Via l'interface web
ou application iPad

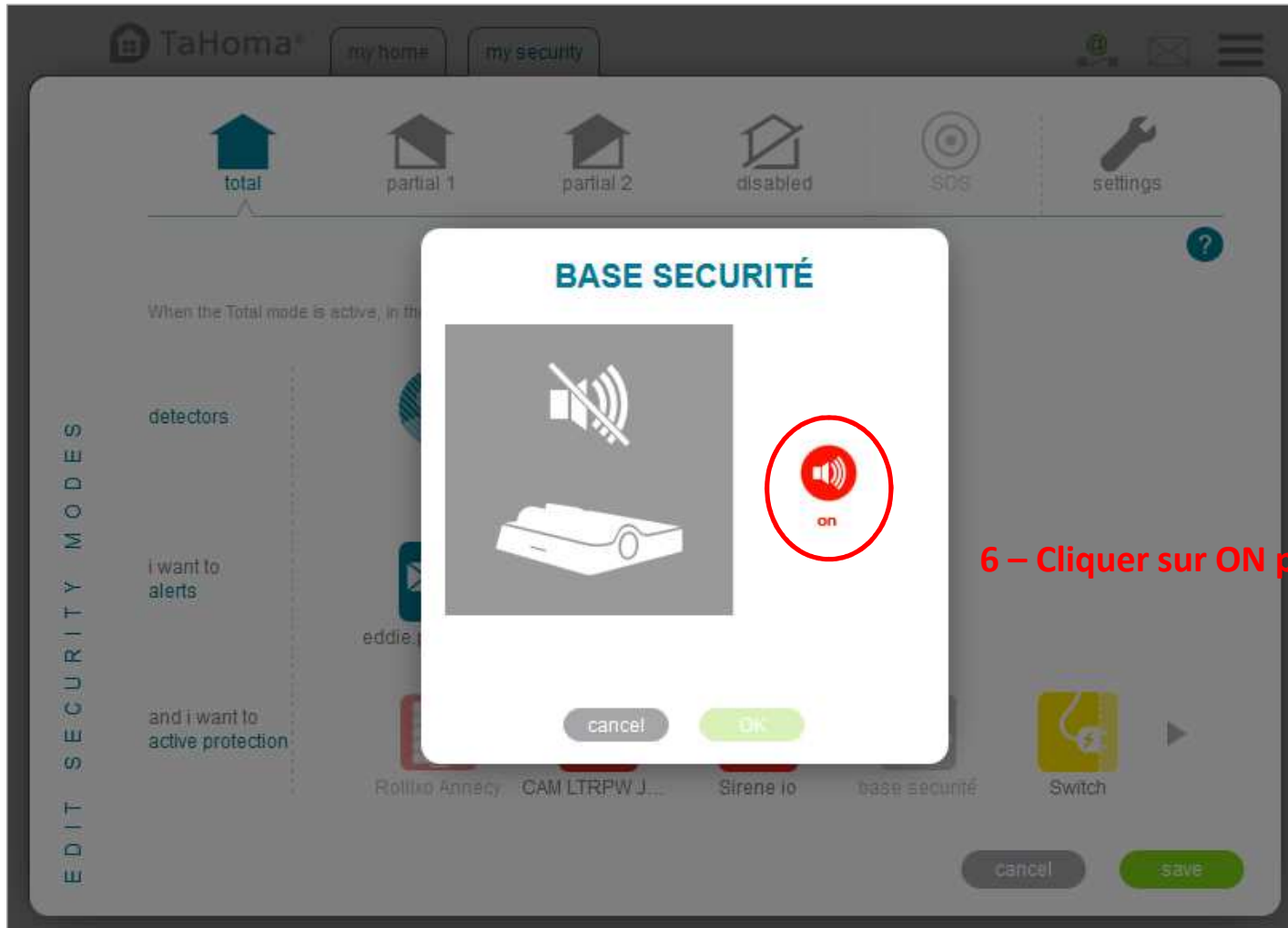

6 – Cliquer sur ON pour l'activer

Via l'interface web
ou application iPad

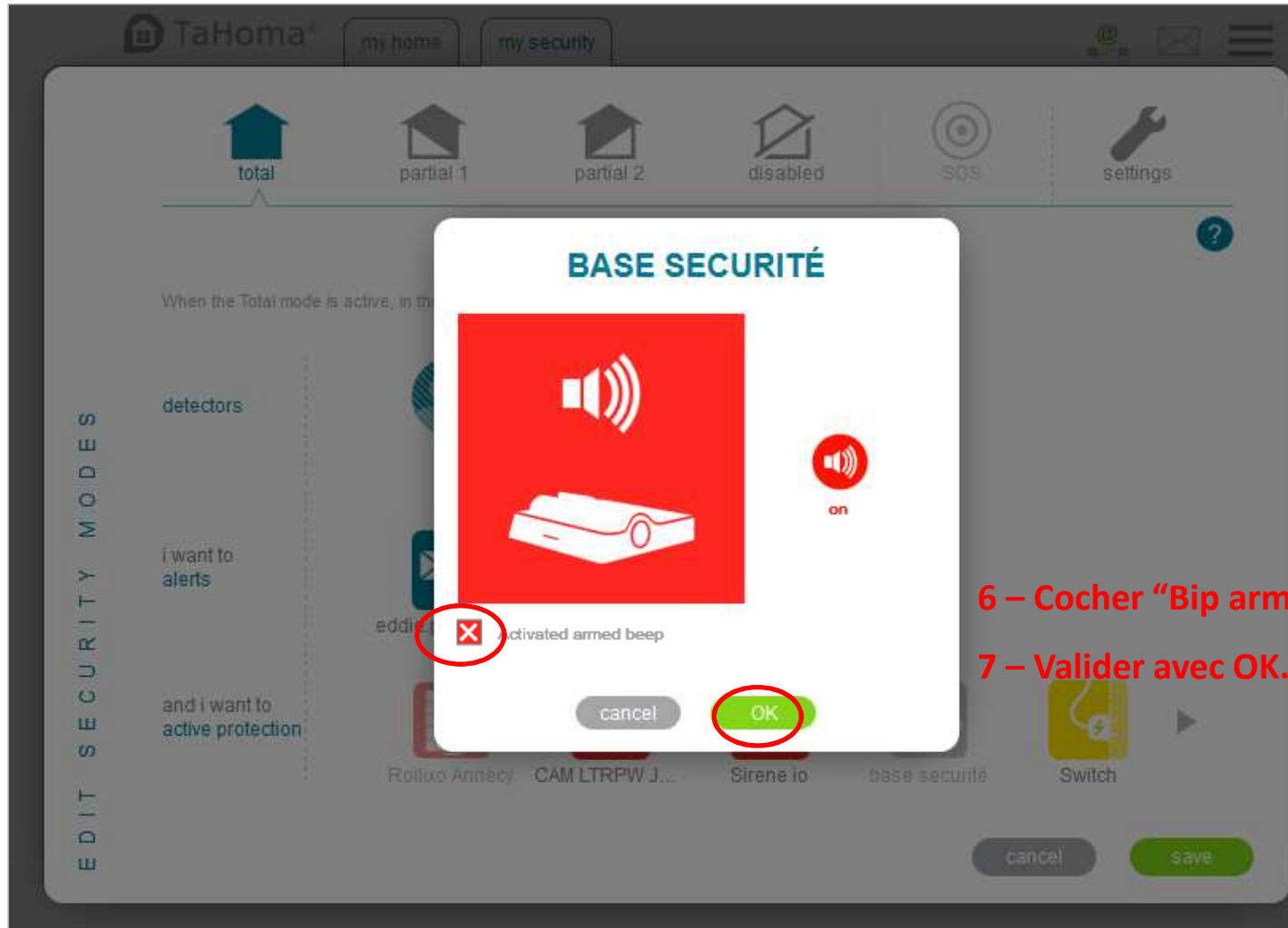

6 – Cocher “Bip armement activé”.

7 – Valider avec OK.

Via l'interface web
ou application iPad

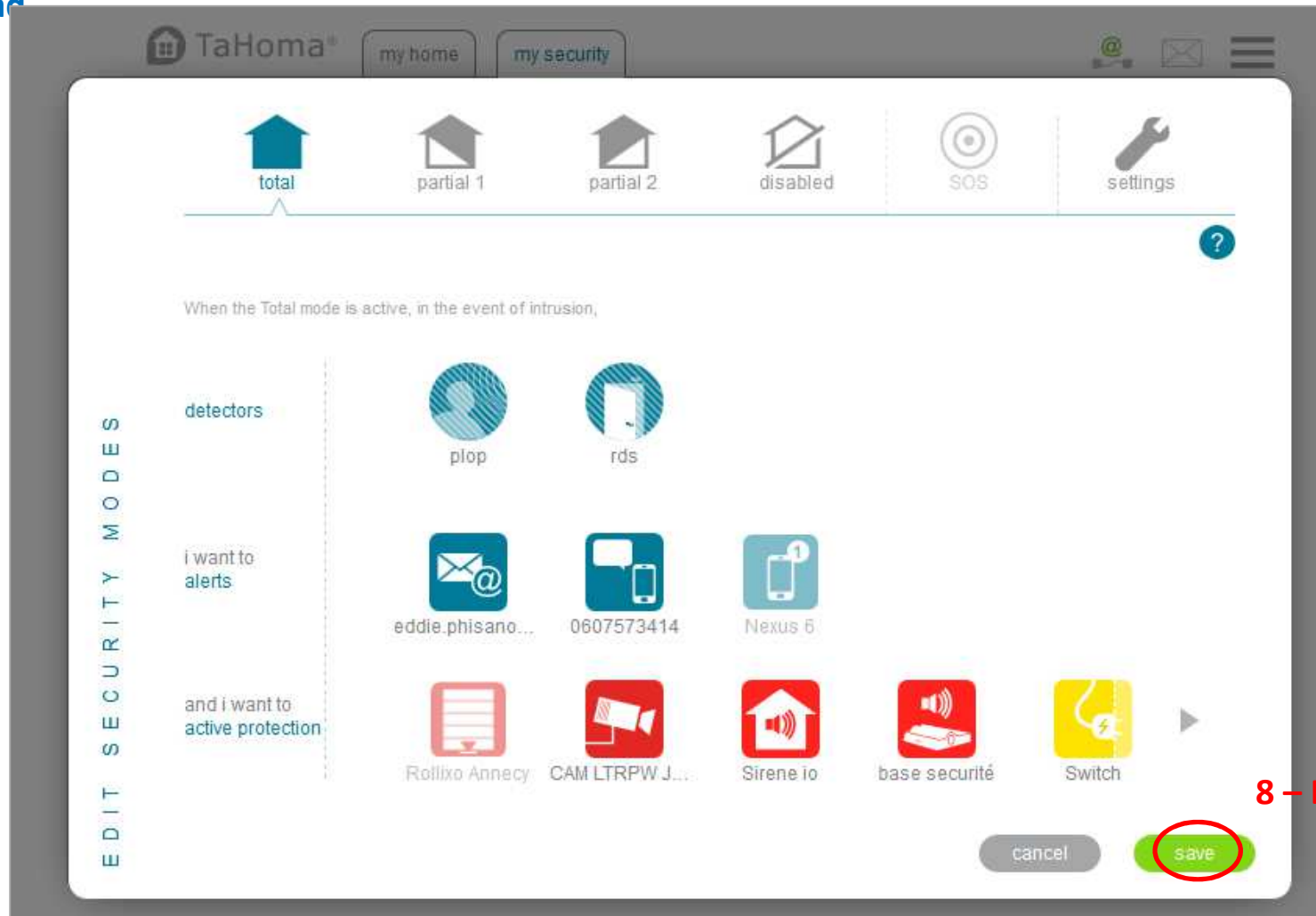

8 - Et sauvegarder.

Recommencer pour chaque mode.